

1 Bedroom

1 BED / 1 BATH

750

SQ. FT.

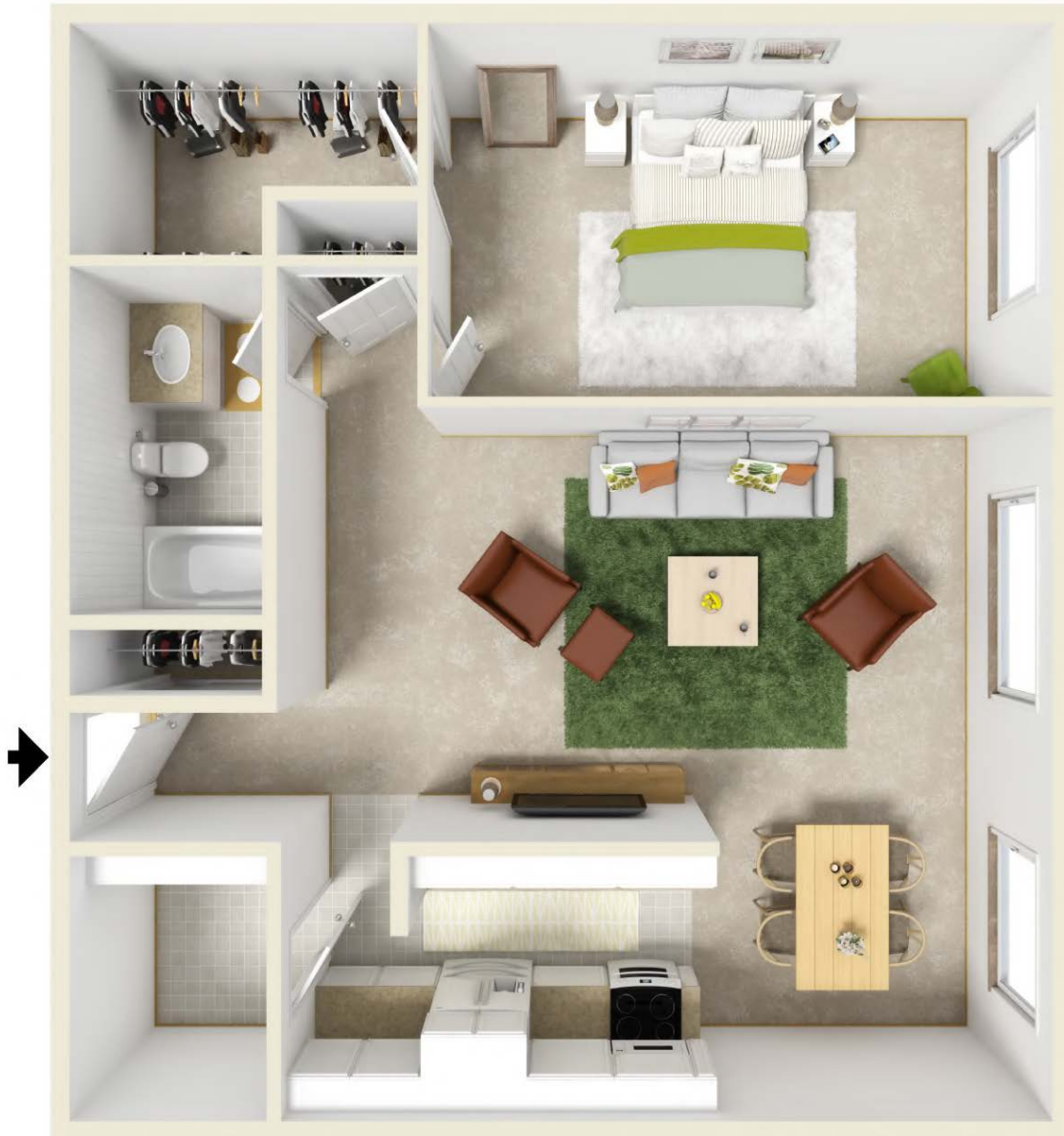

Como Park
APARTMENTS

1385 W. Jessamine Ave. | St. Paul, MN 55108

comoparkapts.com

Floor plans are artist's rendering. All dimensions are approximate. Actual product and specifications may vary in dimension or detail. Not all features are available in every apartment. Prices and availability are subject to change. Please see a representative for details.